

BS-09

1. BUILDING HAS AUTOMATIC SPRINKLER SYSTEM WHERE EVER REQUIRED BY NBC.
2. BUILDING WILL BE DESIGNED (STRUCTURES) AS PER RELEVANT IS CODES FOR EARTHQUAKE RESISTANCE.

THIS IS A PROVISIONAL BUILDING PLAN FOR REFERENCE ONLY. IT IS SUBJECT TO THE APPROVAL OF THE LOCAL AUTHORITY. ANY CHANGES TO BE MADE SHALL BE MADE IN CONFORMANCE WITH THE APPROVAL OF THE LOCAL AUTHORITY.

CONSULTANT ARCHITECT (ATPHQ)
ARCHITECT
NEHA BHARGAVA
CA/20079812

PROJECT: ADDITION & REVISED BUILDING PLAN OF BASEMENT 2 & 3 OF GROUP HOUSING COLONY MEASURING 24.10 ACRES (LICENSE NO. 80 OF 2012 DATED 17/09/2012) IN SECTOR 106, GHRIGRAM MARICAR URBAN COMPLEX BEING DEVELOPED BY ARMD DEVELOPERS LTD. & OTHERS.
OWNER'S SEAL & SIGNATURE

For E-Stamping Limited
Architect's Signature

ARCHITECT'S SEAL & SIGNATURE
NEHA BHARGAVA
CA/20079812

Scale : 1:300
Drawing Title: PHASE-2 BASEMENT-3-PLANS
Drawing No: BS-09

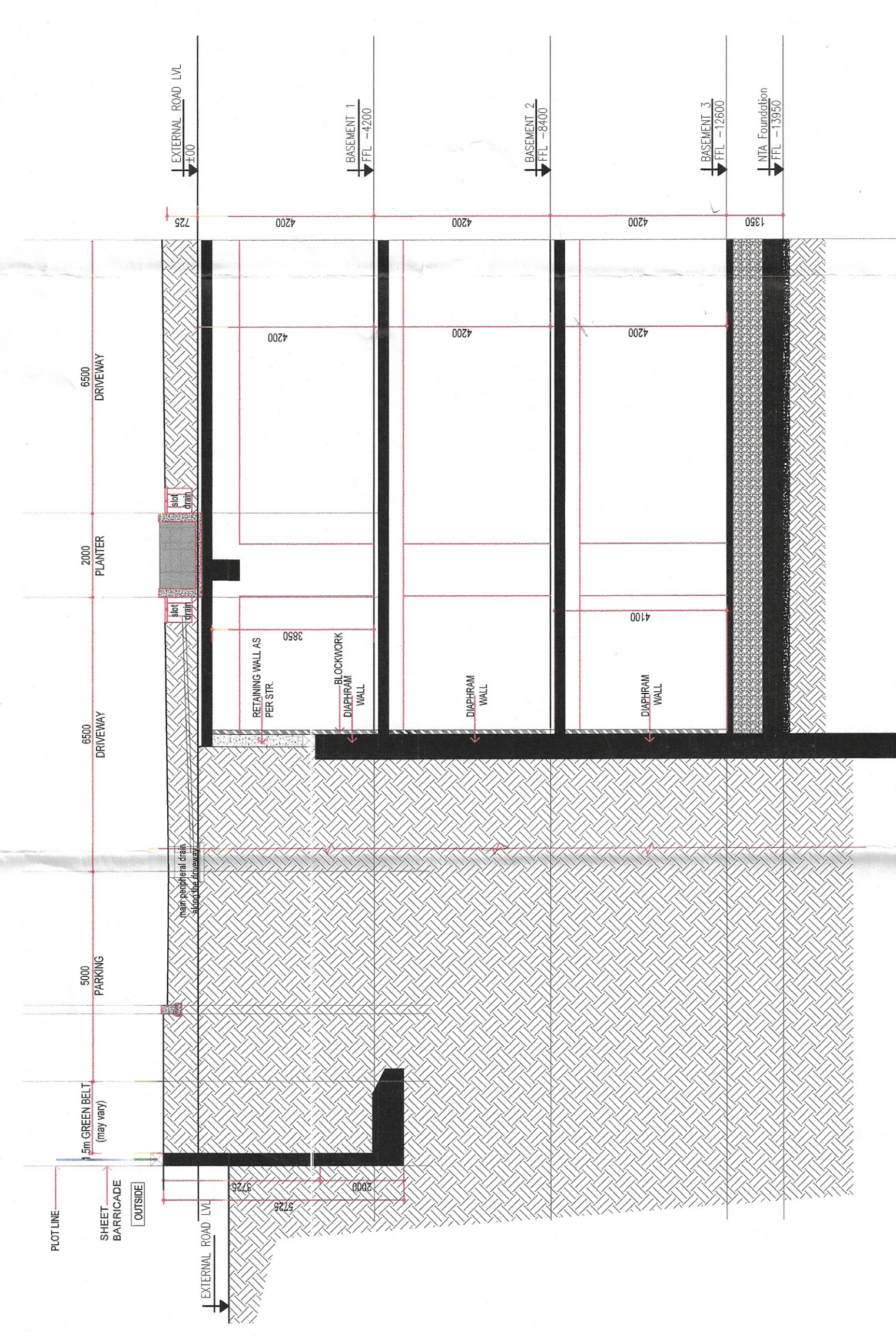

TYPICAL RETAINING WALL & FOUNDATION SECTION



BASEMENT-3
PHASE-2
LV-17600
NO. OF CAR PARKING=625 Nos.

Checked and Approved by the Project Architect (Seal)
In accordance with the provisions of the Indian Standard Code of Practice for Structural Drawing (IS:10261-2009)

For E-Stamping Limited
Architect's Signature

ARCHITECT'S SEAL & SIGNATURE
NEHA BHARGAVA
CA/20079812

Scale : 1:300
Drawing Title: PHASE-2 BASEMENT-3-PLANS
Drawing No: BS-09